

Upper

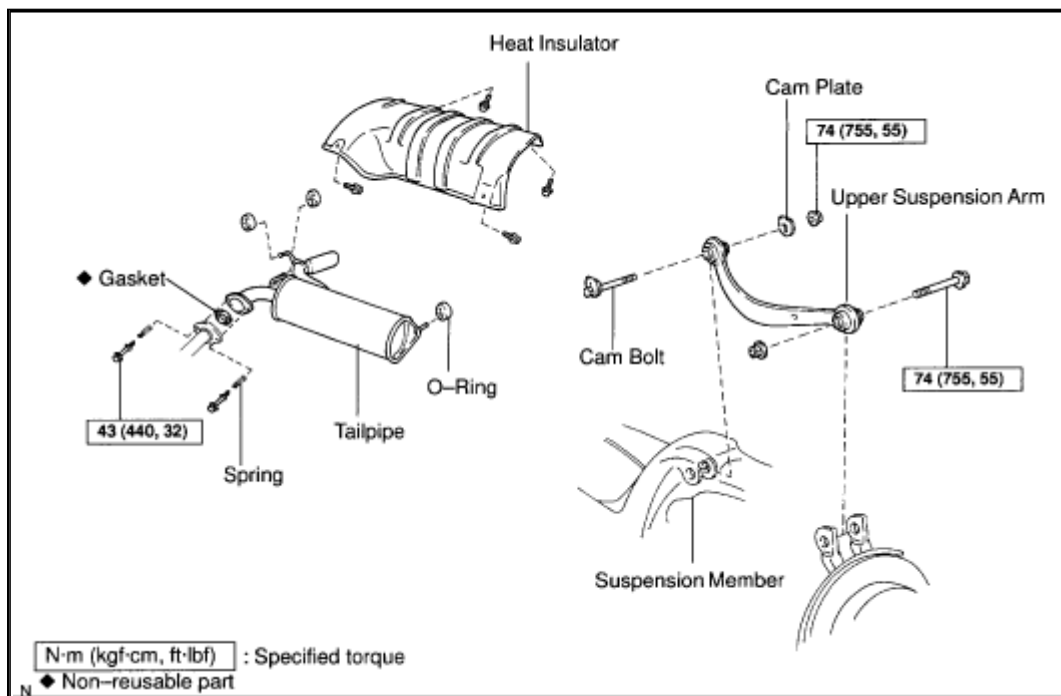

ZOOM

SIZED FOR PRINT

REMOVAL

1. REMOVE REAR [WHEEL](#) Torque: **103 Nm (1,050 kgf.cm, 76 ft. lbs.)**
2. REMOVE TAILPIPE AND HEAT INSULATOR
 - a. Remove the 2 bolts, springs, gasket, 3 O-rings and tail pipe. Torque: **43 Nm (440 kgf.cm, 32 ft. lbs.)**
 - b. Remove the 4 bolts and heat insulator.

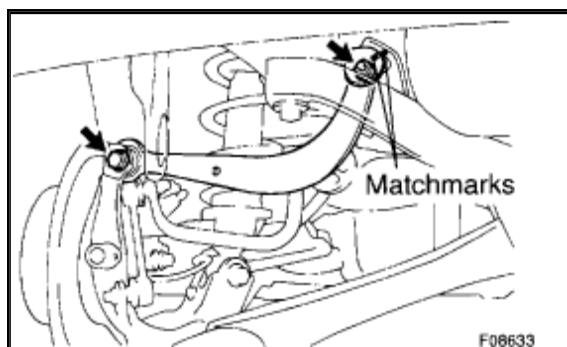

ZOOM

SIZED FOR PRINT

3. REMOVE UPPER SUSPENSION ARM

- a. Place matchmarks on both the cam plate and suspension member.
- b. Remove the nut, cam plate and cam bolt. Torque: **74 Nm (755 kgf.cm, 55 ft. lbs.)** **HINT:** At the time of installation, after stabilizing the [suspension](#), torque the nut.
- c. Remove the bolt, nut and upper suspension arm. Torque: **74 Nm (755 kgf.cm, 55 ft. lbs.)** **NOTICE:** Do not turn the nut. **HINT:** At the time of installation, after stabilizing the [suspension](#), torque the bolt.

INSTALLATION

Installation is in the reverse order of removal.

HINT: After installation, check the rear [wheel](#) alignment.